



MD REALTY
REAL ESTATE SERVICES

Contact Information:

Javier Velasquez
Leasing Agent
913.831.2996 ext 272
javier@mdmgt.com

8201 Mission Road

Prairie Village, KS



DEMOGRAPHICS: (5 MILE RADIUS)

Population	264,751
Households	119,760
Median Age	44
Ave. Income	\$59,919

PREMISES:

- Suite 120 - 707 SF Available
- Suite 260 - 1,533 SF Available
- Suite 261 - 1,428 SF Available

PROPERTY HIGHLIGHTS:

- 13,311 SF, 2-story office / medical building
- Excellent visibility and access along Mission Road and Somerset
- Numerous restaurants and dining establishments in the area



The information contained herein has been given to us from sources we deem reliable. We have no reason to doubt its accuracy but we do not guarantee it. Prices and availability subject to change at any time without prior notice.

www.mdmgt.com



8201 Mission Road

Prairie Village, KS

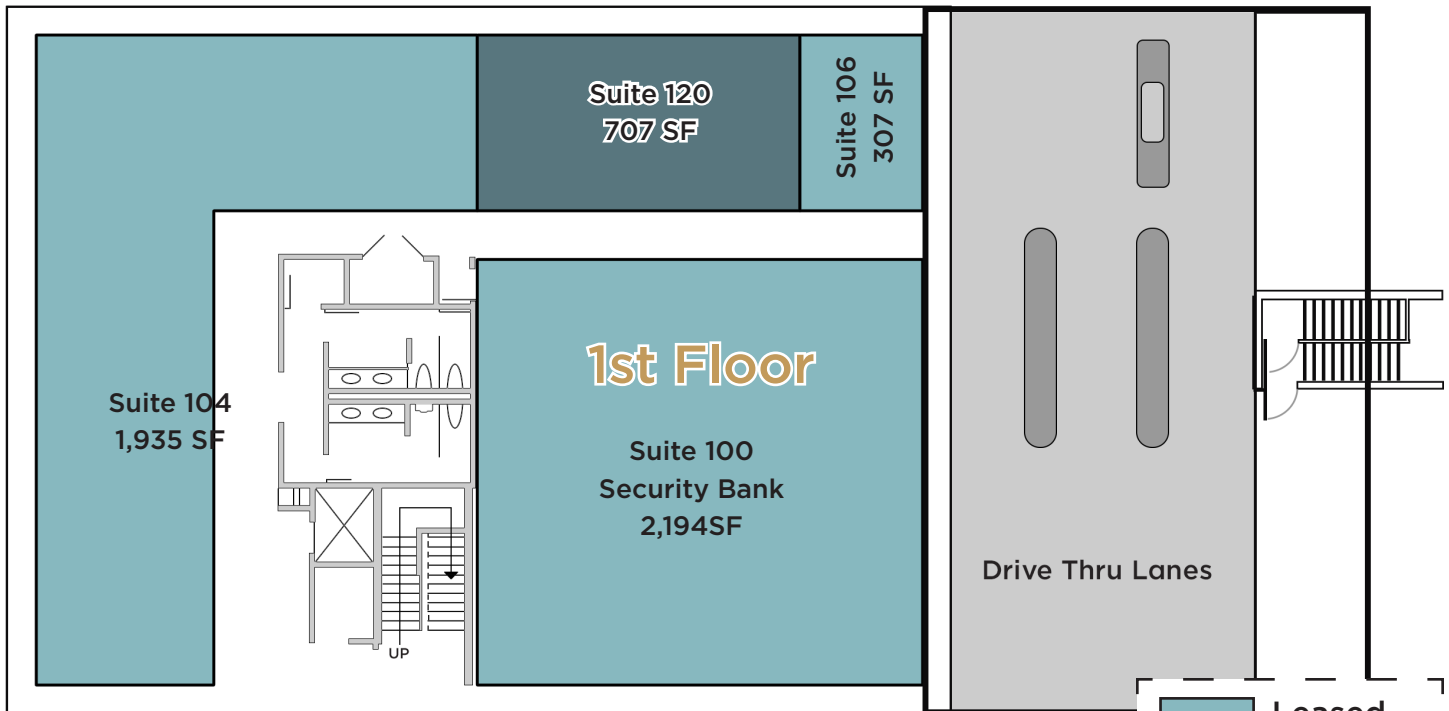

Leased
Available

